

#908 Steering Wheel Replacement

- **Phillips Head Screwdriver**

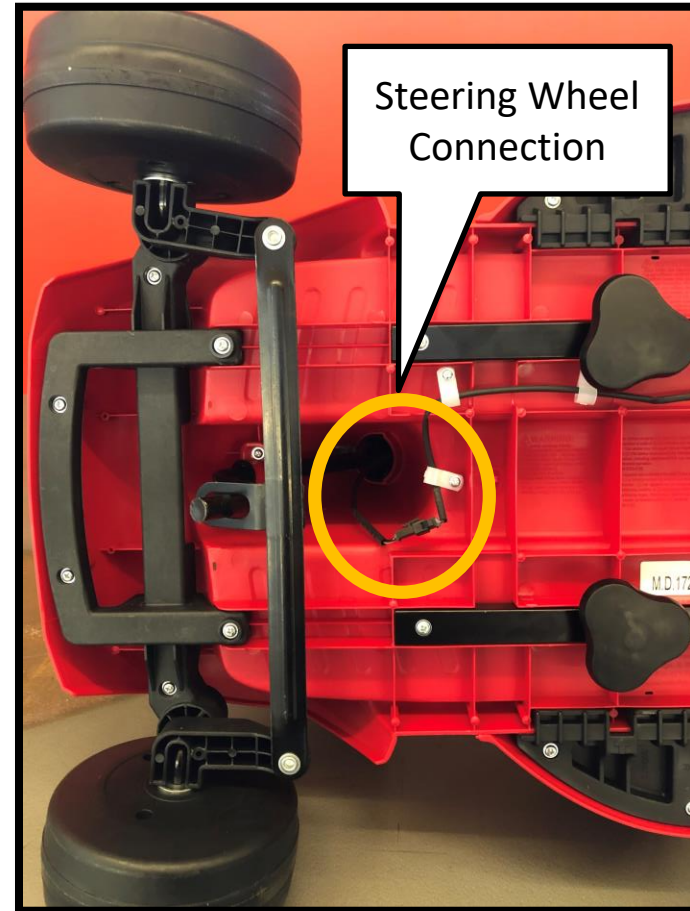

Flip the product onto its side to access the power connection for the steering wheel. This is located between the front wheels.



Disconnect the steering wheel from the power supply by pushing down on the lock tab.

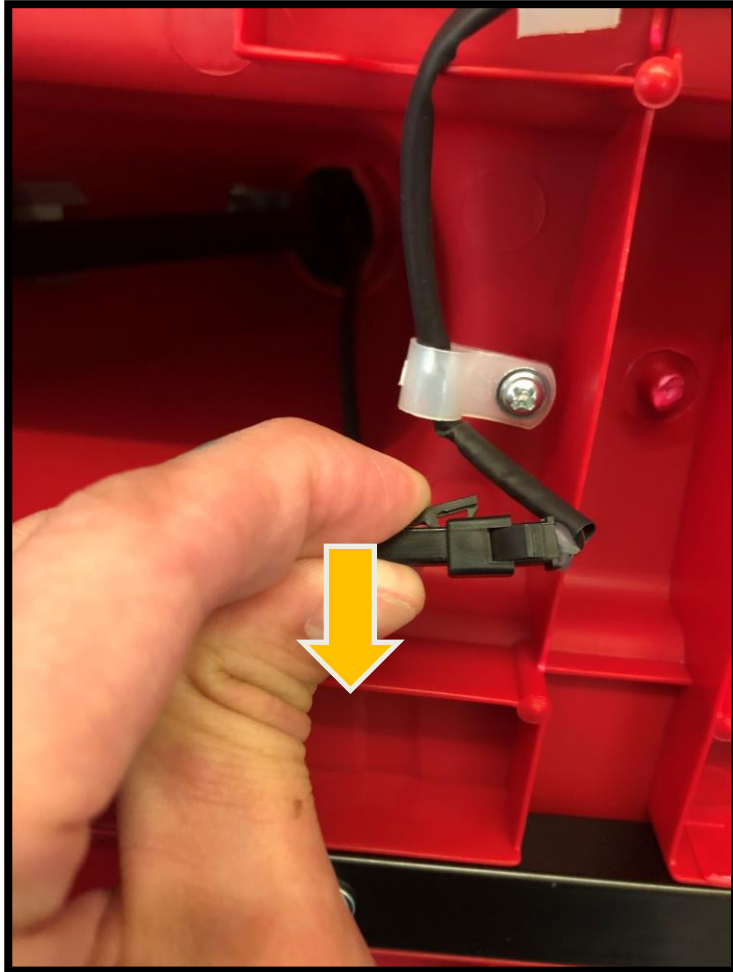

Turn the product over to access the steering wheel.

Locate the head of the bolt on the right side of the steering wheel and use a Phillips head screwdriver to remove.

TIP: If the bolt won't come free from the steering column, try pushing it out from the left-hand side with a screwdriver. Ensure the nut is removed from the left side of the steering wheel before trying this.

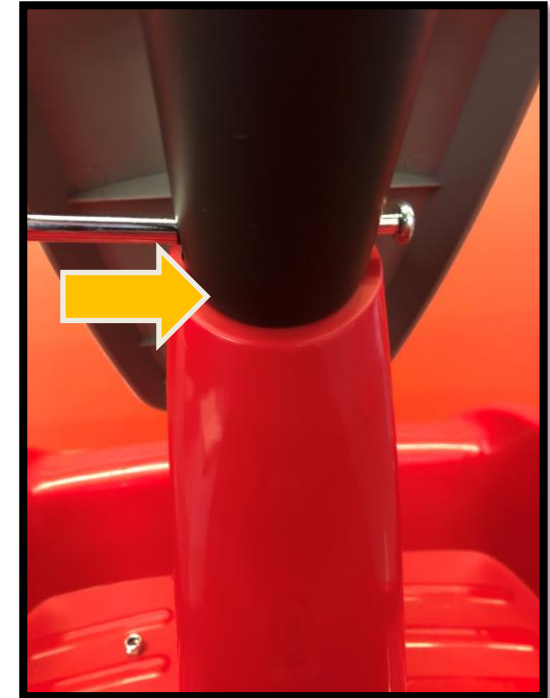

Remove the steering wheel from the steering rod.



Feed the cable of the new steering wheel into the steering column

Push the steering wheel onto the steering bar. Ensure the hole in steering wheel are aligned with the hole in the steering bar.

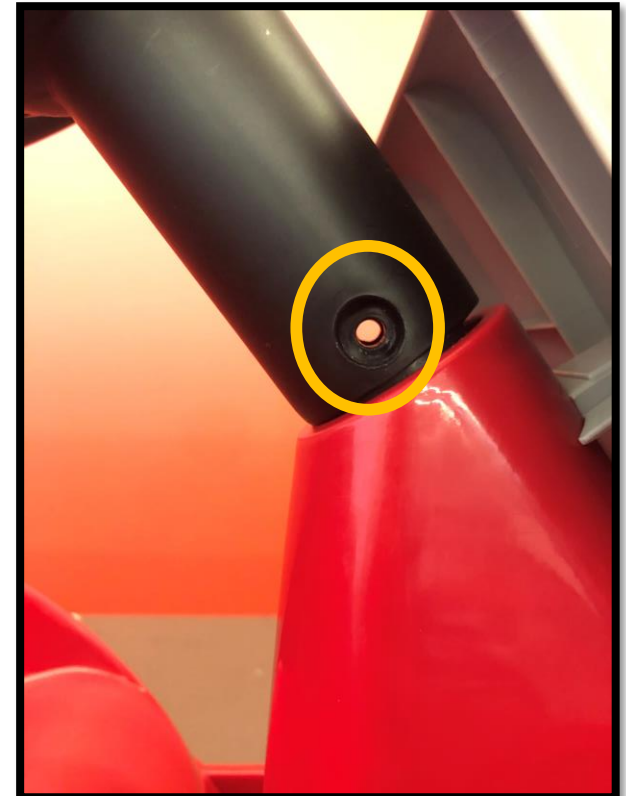

Take the nut from the old steering wheel and insert it into the cutout on the left side of the new steering wheel.

Use a Phillips head to screw the bolt into the new steering wheel.

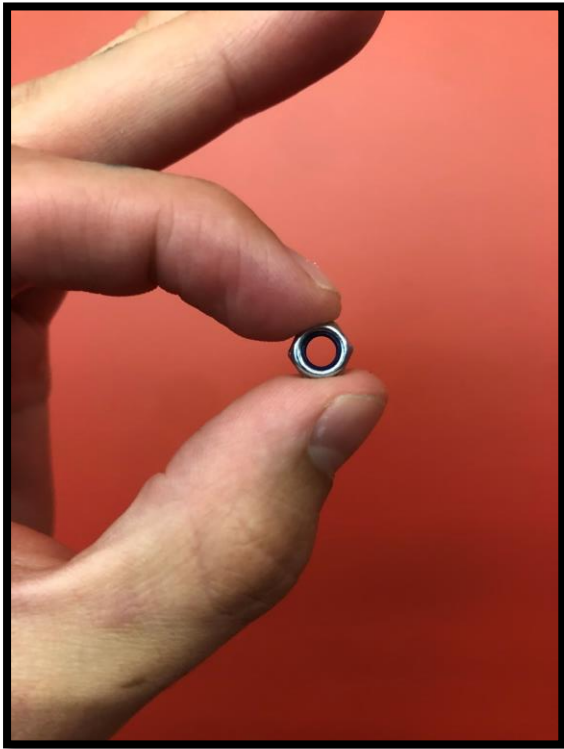

Reconnect the steering wheel to the power supply by pushing the connector together until you hear a 'click'.

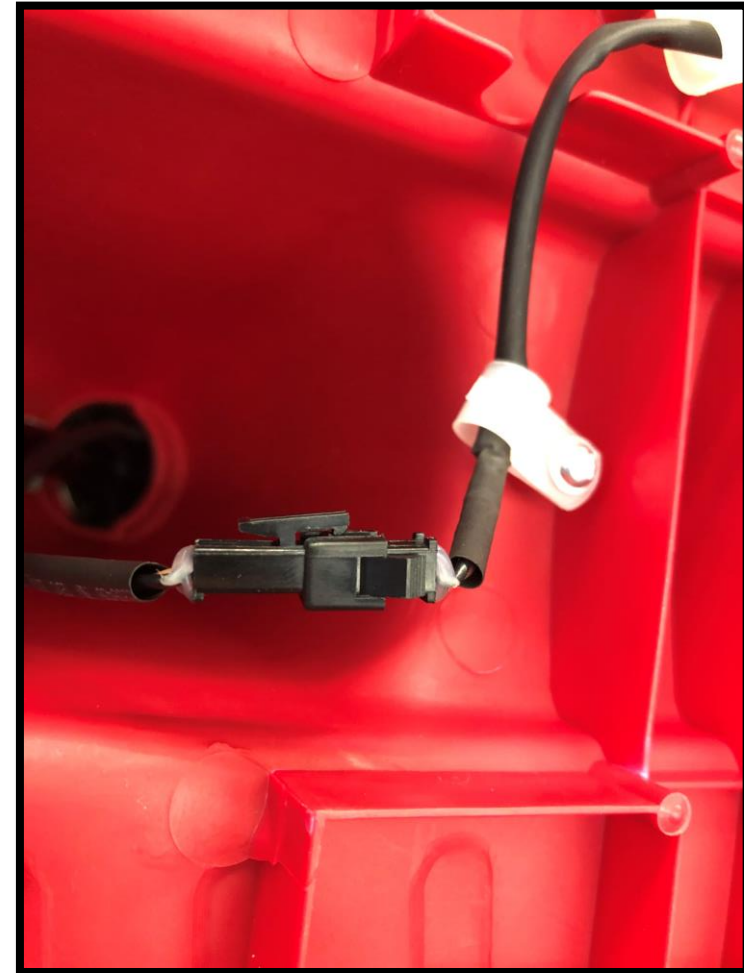
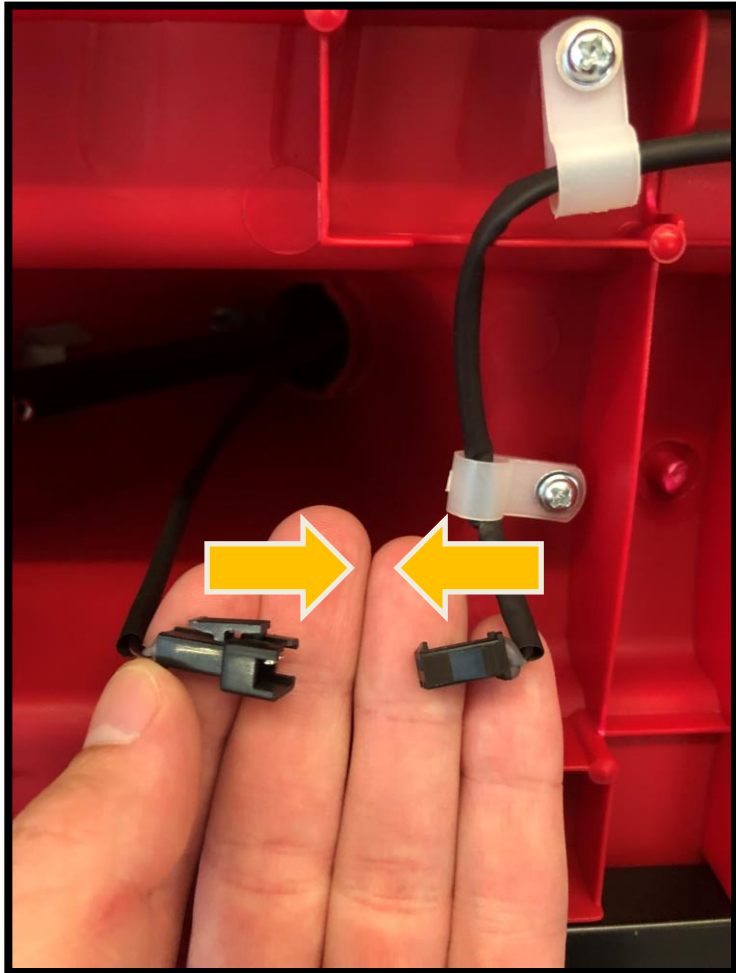

Now you're ready to ride!

